

# St. Bernard Church

415 Tower Hill Road  
North Kingstown, RI 02852  
Parish Office: 401.295.0387  
Fax: 401.295-1713

E-mail: [steering\\_committee@sbcwickford.org](mailto:steering_committee@sbcwickford.org)  
Website: <http://www.sbcwickford.org>

Issue 19

October 26, 2003

## STEERING COMMITTEE REPORT



### Steering Committee

**Tom Orsi, Chair**  
**Jane Allen**  
**Francis Dwyer**  
**Martha Dwyer**  
**Arlene Gardiner**  
**John Gibbons**  
**Elizabeth McGrath**  
**Walter Pannone**  
**Raymond Vallee**

*Accept, O Lord, our thanks and praise for all that you have done for us. We thank you especially for setting us at tasks which demand our best efforts, and hold the promise for leading us to accomplishments which satisfy and delight. Be present with us as we work together: make us responsive to your will and give to us a healthy pride in all we do that we may be good stewards of all things entrusted to us. May the prayers of our patron Bernard help us to keep in mind the wise counsel given long ago "whoever would climb to a lofty height must go by steps, not leaps."*

*We ask this through Christ our Lord.*

*Amen*

## LAST WEEK

The Steering Committee met last week with Michael Viveiros and Martha Werenfels, our Master Plan architects from Durkee, Brown, Viveiros & Werenfels. Among the items discussed was the confirmation that the architectural firm of VHB will complete the topographical survey that they were originally hired to do by the Diocese. This survey will provide us with more details on how level the terrain is and pinpoint the possible wetland areas.

Also, Martha and Michael brought along a few schematic site plans that they have designed. These drawings are **basic conceptual plans** designed only to give us an idea of the general placement and size of potential buildings. To give everyone a chance to see them, two of the drawings have been copied on the reverse side of this insert. Scheme A includes a school on the left and the church and parish center on the right with entry and exit points on both Tower Hill and Ten Rod Road. The area in the top block of each scheme is the back acreage where the potential wetland (or non-buildable) areas are. Scheme G shows the site with no school and a larger parish center. Using this scheme, there is the *potential* to add a school onto the site at a later date. Take a look and let us know what you think of these preliminary drawings.

Because we believe so strongly that a school at St. Bernard should be fully explored, we are go-

## SCHOOL MEETING

ing to give the informational school presentation again on **Sunday, November 9, 2003 at 11AM in the Parish Center**. We'll have coffee and some pastries available for you, and babysitters available for your children at the Parish Center. If you care about the future of Catholic education in South County, please set aside some time for this meeting.

### Question for Sunday, October 26, 2003

What do you think of the preliminary schematic drawings?

Please drop your response in the collection baskets or send an email to [steering\\_committee@sbcwickford.org](mailto:steering_committee@sbcwickford.org). Thanks for your response!

ST. BERNARD CHURCH  
NORTH KINGSTOWN, RHODE ISLAND

**SCHEME A**  
MASTER PLAN

OCTOBER, 2002

DURKEE BROWN  
VIVEROS O'BRIEN FELS  
ARCHITECTS  
30 WEST EXCHANGE STREET  
PROVIDENCE, RHODE ISLAND 02908  
401-261-1100

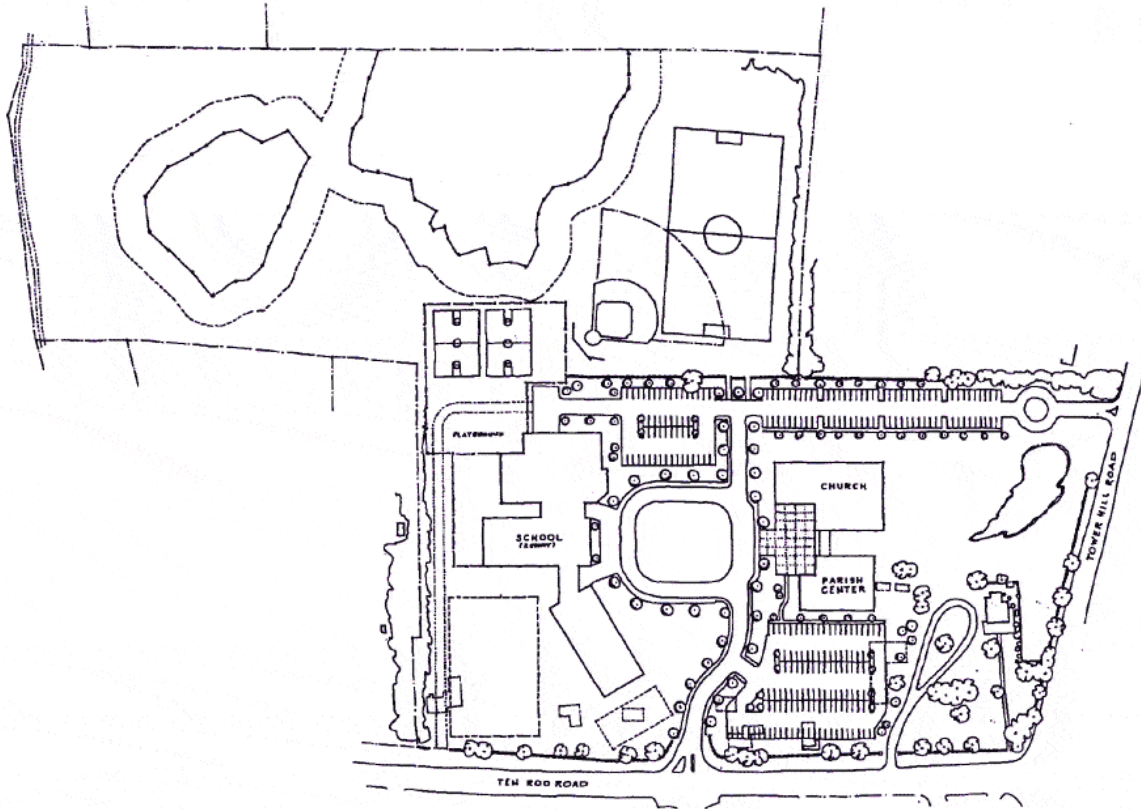

ST. BERNARD CHURCH  
NORTH KINGSTOWN, RHODE ISLAND

**SCHEME G**  
MASTER PLAN

OCTOBER, 2002

DURKEE BROWN  
VIVEROS O'BRIEN FELS  
ARCHITECTS  
30 WEST EXCHANGE STREET  
PROVIDENCE, RHODE ISLAND 02908  
401-261-1100

